

Cartridge (SCALE 1 : 2)

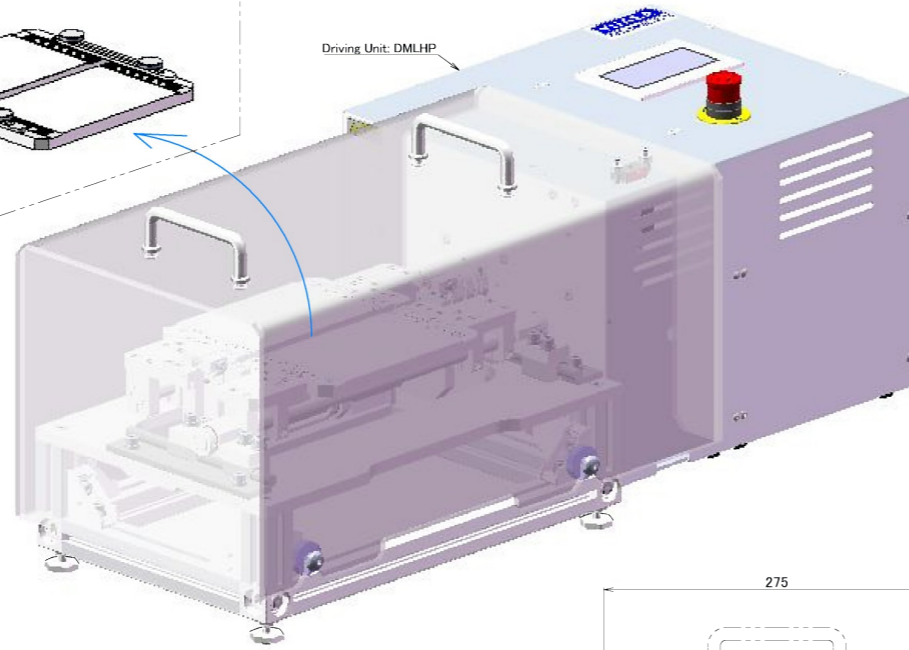

Driving Unit: DMLHP

Transformation Profile

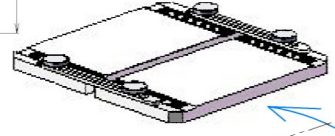
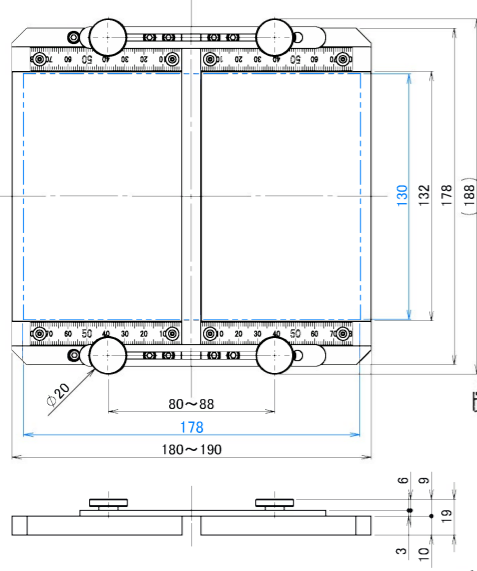
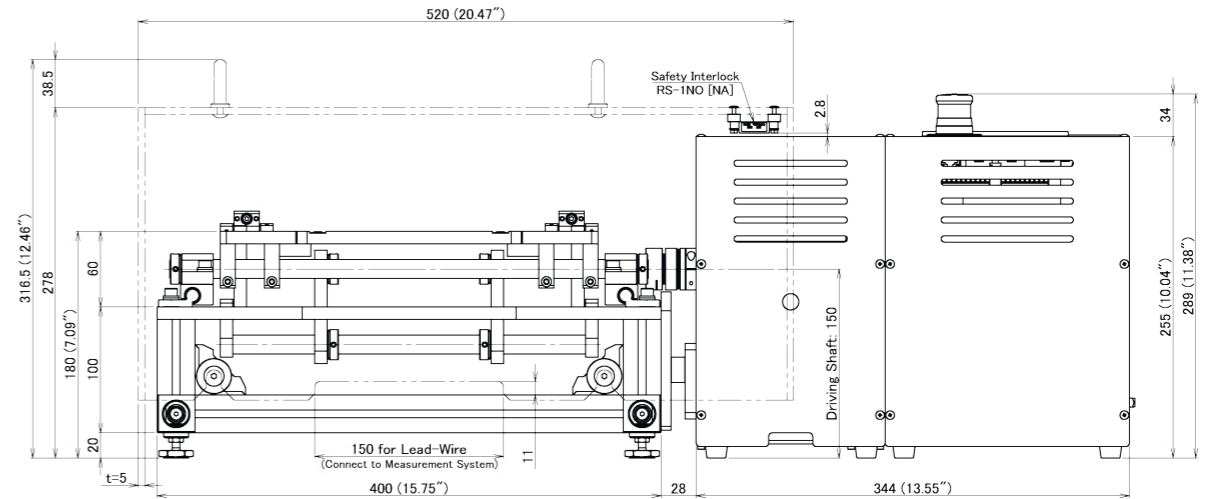
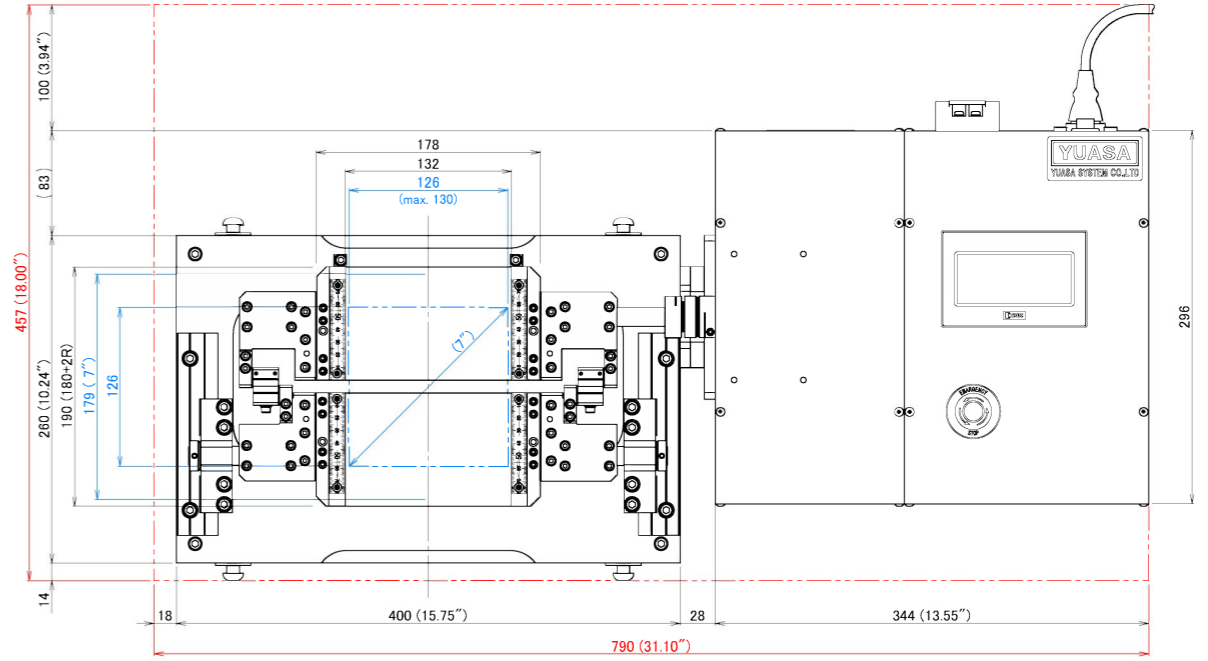
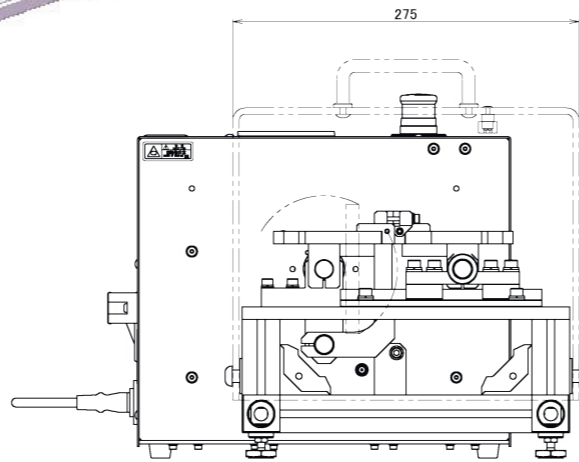
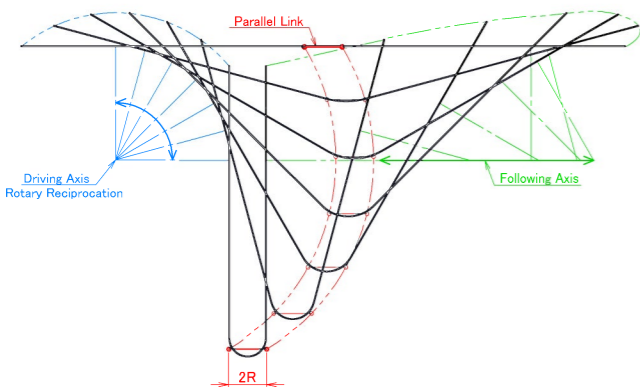
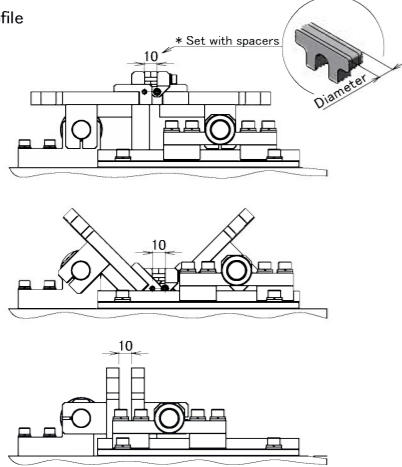

OVER VIEW	<ul style="list-style-type: none"> Testing components folds samples with "Double Jointed Clamshell" structure. It will not place tensile stress on the sample, samples will change naturally. 		
SPECIFICATION of TEST CONDITION	<ul style="list-style-type: none"> Target : Sheet or Linear samples Sample thickness : max. 1 mm Sample width : max. 130 mm Sample length : min. $(\pi R) + (\text{Clamping space})$ mm (Be changed follow to conditions) Bending angle : 150° Bending radius : 0.5~5.0 mm (*half of distance between a pair of plates) Bending force : max. 4.0 N·m Bending speed : 5~30 reciprocation/min. Driving Unit : DMLHP (Permissible torque: 1.8 N·m) Operating Angle : 90 deg. 		
INSTALLATION ENVIRONMENT	Temp. : +5~+40°C (41~104°F) Humi. : 15~85%Rh (No Condensation)		
MASS	<ul style="list-style-type: none"> Testing Machine : about 15.0 kg (33.0 lb) Test Jig : about 8.5 kg (18.5 lb) Cartridge : about 1.0 kg (2.2 lb) Cover, Test jig : about 3.0 kg (7.0 lb) 		
NOTE	* Accessory: Spacer to set the folding radius (5.0 mm, 2.0 mm, 1.0 mm, 0.5 mm, 0.2 mm, 0.1 mm, 0.05 mm : 4 each)		
材質 MATERIAL	第3角法 THIRD ANGLE PROJECTION	尺 度 SCALE	TITLE
質量 MASS	On the margin	1:3	名
表面処理 SURFACE PROCESSING	作成日付 DATE	May 09, 2018	称
熱処理 HEAT TREATMENT	承認 APPROVED	K. Hyodo	名
	検 図 CHECKED	H. Sasaki	番
	設 計 DESIGNED	N. Ando	番
			ET264001S0001-0

- ◇ Components in this drawing
- ET209009A0001: Joint Bracket
- ET264001A0001: Tension-Free Folding (Clamshell)-type
- ET500004A0009: Safety Cover